

NOTTINGHAM CITY COUNCIL

SAFETY OF SPORTS GROUND ACT 1975
FIRE SAFETY AND SAFETY OF PLACES OF SPORTS
ACT 1987

AS AMENDED

GENERAL SAFETY CERTIFICATE

FOR A REGULATED STAND
AT HARVEY HADDEN STADIUM

SAFETY OF SPORTS GROUND ACT 1975
FIRE SAFETY AND SAFETY OF PLACES OF SPORTS ACT 1987
(AS AMENDED)

GENERAL SAFETY CERTIFICATE	1
SCHEDULE A – DEFINITIONS	5
SCHEDULE B - SAFETY STAFF AND CROWD CONTROL.....	9
B.1. General.....	9
B.2. Safety Officers.....	9
B.3. Stewards	9
B.4. Spectators with Disabilities	10
B.5. Spectator Control And Policing.....	10
B.6. Public Safety Incidents and Evacuation.....	11
SCHEDULE C - FIRST AID AND MEDICAL FACILITIES	12
C.1. Accommodation and Equipment.....	12
SCHEDULE D - BUILDINGS, STRUCTURES AND	13
INSTALLATIONS.....	13
D.1. Means of Ingress and Egress.....	13
D.2. Electrical, Mechanical And Heating Installation	13
D.3. General.....	14
SCHEDULE E - FIRE AND FIRE FIGHTING.....	15
E.1. General	15
SCHEDULE F - TESTING AND INSPECTION BY	16
THE HOLDER	16
F.1. Introduction	16
F.2. Inspections and tests before a Specified Activity	16
F.3. Inspections and tests during and after a Specified Activity	17
F.4. Periodic Inspection, testing and servicing of all Installations.....	17

F.5.	Detailed Structural Appraisal	18
SCHEDULE G - RECORDS AND CERTIFICATES		19
G.1.	Records To Be Kept By The Holder	19
G.2.	Certificates	19
APPENDIX 1	SPECIFIED ACTIVITIES	20
	ACTIVITIES COVERED BY THE CERTIFICATE	20
APPENDIX 2	PERMITTED NUMBERS OF SPECTATORS	21
APPENDIX 5	DEVIATIONS FROM THE RECOMMENDATIONS IN THE GREEN GUIDE.	23

SAFETY OF SPORTS GROUND ACT 1975 FIRE SAFETY AND SAFETY OF PLACES OF SPORTS ACT 1987 (AS AMENDED)

INFORMATION

A general safety certificate is required in respect of the use, at sports grounds which provide covered accommodation in stands for spectators and which are not designated sports grounds, for a stand that provided accommodation for 500 or more spectators to view activities at the ground. Responsibility for the safety of spectators lies at all times with sports ground management. It is important to know all the provisions of the Safety of Sports Grounds Act 1975 ('the 1975 Act') and the Fire Safety and Safety of Places of Sports Act 1987 (as amended) ('the 1987 Act'), which are relevant to stadia and stands within their scope. Reference should also be made to the 'Guide to the Safety Certification of Sports Grounds' (The Green Guide).

Reference should be made to the Acts themselves for authoritative information, however the following points are highlighted:

RIGHT OF ENTRY AND INSPECTION

Section 35 of the 1987 Act gives to authorised officers the power to enter and inspect a sports ground at which there is a regulated stand and to make any inquiries as are considered necessary for the purposes of the Act. Authorised officers also have power to examine records of attendance and records relating to the maintenance of safety in a regulated stand at a sports ground.

ALTERATIONS AND EXTENSIONS

While a general safety certificate exists for a regulated stand section 32 of the 1987 Act requires notice of proposals to alter or extend the stand or its Installations, if the alteration or extension is likely to affect the safety of persons in the stand, to be given to the Local Authority ('Certifying Authority') before work is begun on any proposed alteration or extension.

OFFENCES AND PENALTIES

Any responsible person and, if a general safety certificate is in operation, the holder of the certificate, shall be guilty of an offence by:—

- (a) contravening any term or condition of a general safety certificate for a regulated stand;
or
- (b) admitting spectators to a regulated stand at a time when a general safety certificate is not in force,

A person guilty of an offence above shall be liable on summary conviction, to a fine of an unlimited amount ; or on conviction on indictment, to a fine or to imprisonment for a term not exceeding two years or both.

PROHIBITION NOTICES

Section 10 of the 1975 Act (as amended) provides that if the Certifying Authority is of the opinion that the admission of spectators to a sports ground or any part of a sports ground

involves or will involve a risk to them so serious that, until steps have been taken to reduce it to a reasonable level, admission of Spectators to the ground or that part of the ground ought to be prohibited or restricted, the authority may serve a notice (referred to as a "prohibition notice") on the holder of the general safety certificate or the person who appears to the Certifying Authority to be responsible for the management of the ground, prohibiting or restricting the admission of spectators. A prohibition notice may be appealed in accordance with section 10A of the 1975 Act. Any restrictions imposed under a prohibition notice remain in force unless or until amended or annulled by the court.

APPEAL

Section 30(4) of the 1987 Act provides that an interested party may appeal to a Magistrates Court against the inclusion of anything in, or the omission of anything from, or the refusal to amend or replace a general safety certificate for a regulated stand. An appeal under s 30(4) of the 1987 Act must be brought no later than 28 days after receipt of the general safety certificate or notice as appropriate by the interested party.

TRANSFER OF THE CERTIFICATE

If the Holder of the general safety certificate ceases to be the person responsible for the management of the Regulated Stand at the Sports Ground, an application must be made to the Certifying Authority for the transfer of the certificate to some other qualified person.

OTHER LEGISLATION/GUIDANCE

A general safety certificate holder should be aware that apart from the legislation detailed above other acts and guidance apply to the sports grounds. These include health and safety disabilities and civil contingencies legislation; The Regulatory Reform (Fire Safety) Order (2005); Sports Ground and Stadia Guide No.4: 'Safety Management' document and any other specific pieces of legislation or guidance that may have relevant safety implications.

NOTE: No variation of the terms and conditions of the certificate will be permitted other than by the formal consent of the Certifying Authority.

SAFETY OF SPORTS GROUNDS ACT 1975 (AS AMENDED)
THE FIRE SAFETY AND SAFETY OF PLACES OF SPORT ACT 1987(AS AMENDED)

GENERAL SAFETY CERTIFICATE

FOR A REGULATED STAND
AT HARVEY HADDEN STADIUM

Clause 1 In exercise of the powers conferred by the Safety of Sports Grounds Act 1975 (as amended) ('the 1975 Act') and the Fire Safety and Safety of Places of Sport Act 1987 (as amended) ('the 1987 Act') and all other enabling powers, Nottingham City Council ("the Certifying Authority"), hereby issues to: -

MR HUGH WHITE ("the Holder"),

this General Safety Certificate in respect of **Harvey Hadden Athletics Stand at Harvey Hadden Stadium, Wigman Road, Bilborough, Nottingham, NG8 4PB** shown on the Plan being the Regulated Stand

Clause 2 This Certificate includes the Schedules, Appendices, and Drawings attached hereto.

Clause 3 The words used in this General Safety Certificate shall have the meaning assigned to them by Schedule A, the 1975 Act, the 1987 Act and current edition of the Guide to Safety at Sports Grounds, as appropriate.

Clause 4 The Holder shall retain control over the whole and each part of the Regulated Stand and shall take all necessary precautions for the reasonable safety of Spectators admitted to the Regulated Stand. The responsibility for the safety of Spectators at the Regulated Stand lies at all times with the Holder.

Clause 5 The use of the Regulated Stand for Spectator events under this General Safety Certificate is restricted to those activities specified in Appendix 1 and is subject to the terms and conditions herein, unless a Special Safety Certificate has been granted by the Certifying Authority. No ancillary activities, apart from those listed in Appendix 1, are permitted without the prior written consent of the Certifying Authority.

Clause 6 The Holder shall ensure compliance with the terms and conditions of this General Safety Certificate at all times that the Regulated Stand is in use for any Specified Activity.

Clause 7 The Holder shall produce and comply with a written statement of Safety Policy covering the safety of Spectators and employees, outlining a chain of command and covering safety objectives and the means of achieving them. The Holder shall appoint a person at a senior level in the organisation to be responsible for implementation of the Safety Policy. The Holder shall take all necessary steps to ensure that the contents of this Policy is known and understood by all employees and any voluntary workers who may be involved in ground operations. The Holder shall sign and date the Safety Policy and shall ensure that the Policy is implemented, reviewed annually and revised as necessary. The Holder shall forward to the Certifying Authority upon its request a

copy of the Safety Policy and ensure that any revision is sent to the Certifying Authority, within 7 days of the request or of any revision taking effect.

- Clause 8 The Holder shall inform the Certifying Authority of the name of the person at senior level in the organisation appointed to take responsibility for the Safety Policy and its implementation, together with those of the Safety Officer, Deputy Safety Officer/s and Specified Person, who shall be appointed and be of sufficient competence, status and authority to take responsibility for Spectator safety at the Regulated Stand and be able to authorise and supervise safety measures. The Holder shall ensure the Safety Officer, Deputy Safety Officer/s and Specified Person are accountable to the person at senior level of the management of the ground who is responsible for safety policy and its implementation. Any change/proposed change in the above roles shall be notified to the Certifying Authority in writing as soon as is practicable and prior to the change if practicable. The Holder shall set out in writing the duties of the Safety Officer, Deputy Safety Officer and Specified Person and the functions of their post.
- Clause 9 The Holder may appoint a replacement Safety Officer or Deputy Safety Officer to carry out or assist in the general duties of the Safety Officer (or Deputy) or duties for a specific event. Such Appointments shall be notified to the Certifying Authority in writing as soon as is practicable and prior to the event taking place.
- Clause 10 Subject to Schedule B, unless the Safety Officer, Deputy Safety Officer or Specified Person is present at Specified Activities, the capacity of the Regulated Stand will be zero.
- Clause 11 Without prejudice to Clause 21, the Holder shall give the Certifying Authority 14 days' notice in writing of any change of circumstances affecting this Certificate. Any changes affecting this Certificate that could not be foreseen shall be notified to the Certifying Authority in writing as soon as is practicable and in any event within 7 days of their occurrence.
- Clause 12 The Holder (in consultation with the Police, Fire Service, Ambulance Service, the Certifying Authority and such other persons or bodies as may be appropriate) shall produce, review, test and keep up to date documented Contingency Plans for any incident occurring which might prejudice safety or disrupt normal operations at the Regulated Stand. In these Plans, specific tasks shall be assigned to identified post holders or their nominated deputies. The Contingency Plans shall cover all reasonably foreseeable contingencies up to and including the need for partial and/or total evacuation of the Regulated Stand and shall identify appropriate individuals and their respective tasks, including precautions against electrical or mechanical failure.
- Clause 13 The Holder shall carry out training exercises to ensure the procedures as set out in the Contingency Plans operate correctly. Details of training exercises shall be entered in a logbook.
- Clause 14 The Holder shall ensure that the maximum number of spectators that may be admitted at any one time to the Regulated Stand shall not exceed the capacities specified in **Appendix 2** of this Certificate. The Holder shall also ensure that the measures for controlling spectators prescribed in this General Safety Certificate are observed.
- Clause 15 The Holder shall ensure that suitable and sufficient equipment, permanent staff, Stewards and others are provided, to monitor, direct, guide, manage and assist Spectators in accordance with **Schedule B** herein during Specified Activities.

- Clause 16 The Holder shall ensure that suitable and sufficient first aid and medical staff, equipment, facilities and accommodation are provided in accordance with **Schedule C**.
- Clause 17 The Holder shall ensure that all Installations, buildings and structures, including their means of ingress and egress, referred to in this Certificate are at all relevant times kept unobstructed and maintained in good repair and condition as to fulfil their required functions and comply with the requirements of **Schedule D**, and, so far as reasonably practicable, do not put Spectators at risk.
- Clause 18 The Holder shall ensure:-
- a. all reasonable precautions are taken to prevent the outbreak and spread of fire,
 - b. suitable and sufficient equipment is maintained and competent staff are available to deal with an outbreak of fire, and
 - c. compliance with the requirements of **Schedule E** to this Certificate
- Clause 19 The Holder shall ensure that the inspections and testing of structures, equipment and systems at the Regulated Stand are carried in accordance with **Schedule F** herein, at the frequency indicated, or such shorter periods as may be necessary to ensure the reasonable safety of spectators, subject to the frequency of any such inspection and test not exceeding any frequency indicated by a relevant manufacturer of such structures, equipment and systems. The results of these inspections and test shall be recorded and kept as specified in **Schedule G**.
- Clause 20 The Holder shall ensure that any records and or certificates specified in **Schedule G** are kept and made available for inspection by the Certifying Authority at all reasonable times.
- Clause 21 The Holder shall notify the Certifying Authority, in writing, of any proposed change to the Regulated Stand structure or its Installations at least 28 days before any proposed change is made. Any changes, which may involve addition to, alterations or conditions at the Regulated Stand shall be accompanied by two sets of:-
- d. drawings of scale 1:100 to clearly show the proposed change,
 - e. such other capacity calculations, drawings and risk assessments as may be necessary or are further required by the Certifying Authority to enable them to undertake the necessary consultation and to make an informed decision on the proposed change.
- Clause 22 No alteration or addition shall be made to the Regulated Stand, including any structure, installation, fitting, whether temporary or permanent, without prior written authorisation of the Certifying Authority. Any authorised change shall be carried out of the satisfaction of the Certifying Authority.
- Clause 23 The Holder shall draw up and keep up to date plans showing the layout of the Regulated Stand, Sports Ground, buildings, equipment, and all details/ documents and certificates considered necessary by the Certifying Authority in connection with this certificate and shall upon request supply the Certifying Authority with copies.
- Clause 24 Any notice required to be given under this General Safety Certificate shall be provided in writing to:- **Food and Health & Safety Team, LH Box 45, Loxley House, Station Street, Nottingham, NG2 3NG.**

- Clause 25 This Certificate is issued without prejudice to other legislation controlling the construction or use of the Regulated Stand within the Sports Ground or otherwise affecting the Holder, and does not invalidate any statutory obligation upon the Holder. The specific requirements of this certificate shall not be regarded as the limit of the obligation placed on the Holder to take all necessary precautions for the reasonable safety of Spectators admitted to the Regulated Stand.
- Clause 26 Notwithstanding clauses 7 & 12, the Holder shall ensure the following documentation is produced, kept up dated and signed and dated by the Holder. The Holder shall ensure that up-to-date copies of the following are supplied to the Certifying Authority upon request:-
- f. plans showing the layout of the stand, buildings, equipment, and all details considered necessary by the Certifying Authority in connection with the General Safety Certificate;
 - g. duties of the Safety Officer;
 - h. Safety Policy; and
 - i. Contingency Plans.

With effect from **25th September 2017** this certificate will replace all previous certificates and will be reviewed by the Certifying Authority.

Signed:..... Date.....

Lorraine Raynor
Chief Environmental Health and Safer Housing Officer

Community Protection
Nottingham City Council
Loxley House
Station Street
Nottingham
NG2 3NG

SCHEDULE A – DEFINITIONS

‘the Ambulance Service’

means the Chief Executive Officer of the East Midlands Ambulance Service NHS Trust or any other such officer designated by him/her.

‘Building Regulations’

means the Building Regulations 2010 as amended

‘Buildings and Structures’

in relation to the Sports Ground means all buildings, structures and parts thereof including means of access and egress.

‘Carer/s’

means any person assisting or caring for a Wheel Chair Spectator in the Wheel Chair Spectator Area

‘Certifying Authority’

means the Food and Health & Safety Team of Nottingham City Council

‘Child’

means a person who has not attained the age of 17 years, and the word ‘Children’ shall be construed accordingly.

‘Competent Person’

in relation to the testing and certification of electrical systems and Installations, means one of the following:

- a) a corporate member of the Institution of Electrical Engineers; or
- b) a contractor currently enrolled with the National Inspection Certifying Authority for Electrical Installation Contracting or Electrical Contractors' Association; or a suitably qualified representative of the Electrical Supply Authority.

in relation to the testing and certification of Building and Structures , means one of the following:-

- a. Chartered Structural Engineer;
- b. Chartered Surveyor (Building Surveying Division);
- c. Chartered Civil Engineer; or a person who in the opinion of the Certifying Authority possesses similarly qualifications to those at a, b or c above.

‘Contingency Plan’

means a plan for any incident occurring which might prejudice safety or disrupt normal operations at the Regulated Stand, including precautions against electrical or mechanical failure, which assigns specific tasks to identified post holders or their nominated deputies, covering all reasonably foreseeable contingencies up to and including the need for partial and/or total evacuation of the Regulated Stand.

‘Dedicated First-Aid Room’

means a fully resourced room within Harvey Hadden Leisure Complex set aside for treating members of public as required.

‘Deputy Safety Officer’

means a person vested with all the competence and authority normally held by the Safety

Officer

'Electrical Installation'

Means an assembly of associated electrical equipment having co-ordinated characteristics to fulfil specific purposes. (from BS 7671:2008)

'Emergency Lighting'

means a system of escape route lighting which illuminates in the event of a failure of the general lighting circuit to enable free movement within the Regulated Stand and exits therefrom.

'Emergency Services'

means the Police, the Ambulance Service and the Fire and Rescue Service

'the Fire and Rescue Service'

means the Chief Officer of Nottinghamshire Fire & Rescue Service, or such other officer designated by him/her.

'Fire Resisting'

means the construction is capable of resisting the action of fire for not less than half-an-hour, (or such other period as may be specified by the Certifying Authority) in accordance with the appropriate British Standard. or as defined in the current version of the Approved Document B of the Building Regulations 2010. (Volume 2) -Fire Safety

'Gas Safety Regulations'

means the Gas Safety (Installation and Use) Regulations 1998

'Green Guide'

means the current edition of the 'Guide to Safety in Sports Grounds' produced by the Department for Culture Media and Sport.

'Holder'

Means the person to whom the General Safety Certificate was issued as the person responsible for the management of the ground.

'Installations'

includes all or part of any radial fencing, and any electrical, mechanical and heating Installations.

'Medical Practitioner'

means a qualified Medical Practitioner, registered with the General Medical Certifying Authority, who has received training in pre-hospital (immediate) care and major incident management.

'Non Combustible'

means material capable of being classified as non-combustible if subjected to the test for non-combustibility prescribed in the appropriate British Standard, or such other material or combination of materials as the Certifying Authority accepts as being non-combustible.

'Occupationally Competent' means a person who has sufficient training and experience to meet the national occupational standards relevant to the task within their identified role.

'Paramedic'

means a person who holds a current certificate of proficiency in ambulance Paramedical skills,

issued by the Institute of Health Care and Development (IHCD), and who has immediate access to the appropriate level of specialist equipment, including drug therapy, as stipulated and approved by the relevant Paramedical Steering Committee. A Paramedic crew, as a minimum, consists of a Paramedic plus an ambulance technician, trained to IHCD Standard

'the Plan'

means the documents attached to this Certificate in Appendix 3 and Appendix 4.

'Planned Preventative Maintenance Schedule'

means a schedule that complies with the requirement of Schedule F and deals with periodic inspection testing and assessment and details structural appraisal of all structures and installations relating to the Regulated Stand

'the Police'

means the Chief Constable of Nottinghamshire Police or such other officer designated by him/her.

“the Police Commander”

means an officer designated by the Police for the purpose of commanding Police activities.

'Regulated Stand'

means the covered seating area at Harvey Hadden Stadium, Wigman Road, Bilborough, Nottingham, NG8 4PB as shown as Harvey Hadden Athletics Stand on plan [Ref Drawing Number POS/121001/15-2] at Appendix 3 in respect of which a General Safety Certificate under Part III of the 1987 Act is required.

'General Safety Certificate'

means this certificate being a General Safety Certificate in respect of the use of the Regulated Stand for viewing an activity or a number of activities specified at Appendix 1 during an indefinite period commencing on at the date of this certificate, not being a Special Safety Certificate specified under section 26(10)(b) of the 1987 Act.

'Safety Officer'

means a person, with sufficient training, experience and knowledge to assess and manage risks relating to the Regulated Stand and has sufficient authority for the direction and control of spectators, employees, agents, contractors, franchise holders and their employees within the Regulated Stand.

'Safety Officer's Control Point'

means the control room (CR) as shown on the Plan [Ref Drawing Number POS/121001/15-1] at Appendix 4

'Safety Policy'

means the policy produced covering the safety of spectators, employees, outlining a chain of command and covering safety objectives and the means of achieving them. The policy must make reference to the Stewarding Plan; Medical Plan; Fire Safety Management Plan; Contingency Plan, Major Incident Plan and Maintenance Plan.

'Safety Staff'

means the Holder, a person designated by them, the Safety Officer, Deputy Safety Officer and Specified Person, and all persons under their control who are engaged in the management of

the Regulated Stand and the safety, direction and control of spectators, including employees, agents, Stewards, contractors, franchise holders and their respective employees.

‘Special Safety Certificate’

means any Safety Certificate issued under s26(10(b) of the 1987 Act in respect of the use of the stand for viewing an activity or a number of activities specified in a such a certificate on an occasion or series of occasion so specified.

‘Specified Activity’

means any of the activities listed in Appendix 1 and the duration of the Specified Activity shall be construed as including the whole period when Spectators of the Specified Activity are within the Regulated Stand.

‘Specified Person’

means a person who does not hold (or is not working towards) a level 4 spectator safety qualification on the relevant qualification framework, but nevertheless has the necessary ability, knowledge, and skill to assess and manage risks relating to the Regulated Stand and has sufficient authority for the direction and control of spectators, employees, agents, contractors, franchise holders and their employees within the Regulated Stand; and the appointment of whom has been agreed in writing with the Certifying Authority.

‘Spectator’

means persons viewing a Specified Activity including disabled persons from the Regulated Stand.

‘Sports Ground’

means any place where sports or other competitive activities take place in the open air and where the accommodation has been provided for Spectators, consisting of artificial structures or of natural structures artificially modified for the purpose.

‘SGSA’

means the Sports Grounds Safety Authority.

‘Steward’

means a person trained, or being trained, to a recognised national Standard, employed or contracted by management to act in accordance with the general recommendations of the Green Guide and the specific requirements of this General Safety Certificate.

‘Surface Spread of Flame Classification’

means the class into which a material falls when tested for surface spread of flame in accordance with the appropriate British Standard or as defined in the current version of the Approved Document to Part B (Fire Safety) of the Building Regulations 2010.

SCHEDULE B - SAFETY STAFF AND CROWD CONTROL

B.1. General

- B.1.1 The Holder shall be responsible for ensuring that mechanisms are in place to enable the effective management of Spectator safety by Safety Staff, which shall include the production of a Stewarding plan in accordance with the Green Guide.
- B.1.2 Each member of Safety Staff shall be adequately trained in safety procedures in accordance with their responsibilities.
- B.1.3 The Holder must ensure that a suitable and sufficient risk assessment is carried out for every event involving a Specified Activity to:
 - a. determine whether Safety Staff need to be present where 500 or less Spectators are expected at or attend an event.
 - b. enable the final number, location and duties of the Safety Staff to be determined so that Spectator safety is managed effectively.
- B.1.4 Safety Staff shall be made aware of the provisions of Section 35 of the Fire Safety and Safety of Places of Sports Act 1987 which authorises certain Officers of the Certifying Authority to enter a Sports Grounds and inspect a Regulated Stand at any reasonable time, upon production of written authorisation.

B.2. Safety Officers

- B.2.1 The Holder shall ensure the appointment of a Safety Officer and Deputy Safety Officer, both of whom shall be Occupationally Competent, and provide them with detailed job descriptions clearly identifying the functions of their posts.
- B.2.2 The Holder may appoint a Specified Person only with the express written consent of the Certifying Authority. Where a Specified Person is appointed, they must be provided with a detailed job description clearly identifying the function of their post.
- B.2.3 During a Specified Activity, the Safety Officer, Deputy Safety Officer or Specified Person shall be easily identifiable and shall be in attendance at the Safety Officer's Control Point or elsewhere in the Sports Ground but must be easily contactable from there. The Safety Officer on duty shall not be engaged in any task which will prevent him/her from exercising the principal duty of ensuring safety during a Specified Activity.

B.3. Stewards

- B.3.1 The number of Stewards provided should not fall below those stated within the Stewarding plan.
- B.3.2 All Stewards shall be fit and active and shall be aged ideally not less than 18 years and have the character and temperament to carry out the duties required of them.
- B.3.3 The Holder shall be required to ensure a register of Stewards is maintained, recording their attendance and post as well as their training and qualifications.
- B.3.4 Each Steward shall be readily recognisable with a high visibility and distinctly coloured and numbered surcoat or tabard (or such other clothing approved in advance by the Certifying Authority) uniquely identifiable to the individual and worn outside his/her clothing.
- B.3.5 The chief Steward and each senior Steward shall be readily recognisable by the wearing of a high visibility surcoat or tabard (or such other clothing approved in advance by the

Certifying Authority), which is distinctive from that worn by the Stewards, uniquely identifiable to the individual and worn outside his/her clothing.

B.3.6 The basic duties of Steward include:

- a. controlling or directing Spectators who are entering or leaving the Regulated Stand to help achieve an even flow of people in, to and from the viewing areas;
- b. recognising crowd conditions so as to ensure the safe dispersal of Spectators on terraces or viewing slopes and the prevention of overcrowding;
- c. staffing entrances, exits and other strategic points, especially exit gates and doors which are not continuously open while the Regulated Stand is in use;
- d. undertaking specific duties in the event of an emergency or as directed by the Safety Officer (or, where appropriate, any senior Police officer present).

B.3.7 The Holder shall ensure that Stewards are briefed on their deployment, and their general and emergency duties, and a record of the briefing kept in a log book.

B.3.8 Before beginning duty at a Specified Activity, each Steward shall be briefed thoroughly, be handed a copy of his/her instructions and be made fully aware of his/her general responsibilities and his/her duties in the event of an emergency. Records shall be kept of such briefings as specified in Schedule G. De-briefing of Safety Staff shall take place after the Specified Activity to ensure that incidents or problems are referred to the Safety Officer/ Deputy Safety Officer/ or other person appointed take responsibility for Spectator safety at the Regulated Stand and be able to authorise and supervise safety measures for follow up action.

B.3.9 No Steward shall leave their place of duty during a Specified Activity without the permission of the appropriate Safety Officer, Deputy Safety Officer/ or other person appointed take responsibility for Spectator safety at the Regulated Stand and be able to authorise and supervise safety measures, who shall ensure suitable re-placement Safety Staff are in place before the position is vacated.

B.3.10 Stewards shall be located throughout the Regulated Stand and particularly at key points where control is most needed, such as in gangways, tops of staircases, and at each exit or entrance.

B.3.11 All Stewards shall be told before each Specified Activity the location of the Safety Officer's Control Point and the name of the Safety Officer/ Deputy Safety Officer/ Specified Person or other person appointed to take responsibility for Spectator safety at the Regulated Stand and be able to authorise and supervise safety measures on the day in question.

B.3.12 No Steward, whether directly employed or supplied by an agency, shall be deployed without proper training unless accompanied by a Steward who has been so trained.

B.4. Spectators with Disabilities

B.4.1 The Holder shall ensure that accommodation in the Regulated Stand provided for Spectators with disabilities is safe, properly designed and managed. Entrance and exit routes must be made available for disabled Spectators together with safe evacuation procedures.

B.5. Spectator Control And Policing

B.5.1 Where a request is made for Police attendance, it shall be for the Police Commander to determine the appropriate level of policing inside the Regulated Stand.

- B.5.2 The Holder shall enter into a written statement of intent with the Police setting out their respective responsibilities for crowd safety and control where a request has been made for police attendance. Any variation in the statement must be agreed in writing in advance of the Specified Activity to which it relates. Note: The Statement of Intent is not a contract but an agreement on respective areas of responsibility.

B.6. Public Safety Incidents and Evacuation

- B.6.1 The Holder shall assess in writing the risk of incidents prejudicing public safety or disrupting normal operations and where a risk of such an incident is identified shall produce a Contingency Plan
- B.6.2 The Contingency Plan shall be reviewed after any incident, near miss or exercise or following permanent or temporary changes made to the structures or Installations at the Regulated Stand. Where, following any review, the Holder revises the Contingency Plan, a copy of the revisions should be forwarded to the Certifying Authority within 7 days of the revisions taking place.
- B.6.3 The Holder shall carry out training exercises at least once a year so as to ensure the emergency procedures as set out in the Contingency Plan operate correctly. Details of training exercises, including its duration, the instruction provided and the personnel involved shall be entered in a log book.
- B.6.4 Where it has been determined that a Safety Officer, Deputy Safety Officer or Specified Person is not required at a Specified Activity, the Holder shall ensure instructions are made available to the organiser of a Specified Activity to enable them to deal with all reasonably foreseeable contingencies up to and including the need for evacuation of the Regulated Stand.
- B.6.5 A public address system shall be provided and operated by a person nominated by the Holder. The system shall be used for the carrying out of emergency evacuation procedures for the Regulated Stand, when considered necessary.
- B.6.6 The public address system shall be capable of communicating information to the Regulated Stand.
- B.6.7 No Spectator shall be admitted to the Regulated Stand unless the public address system is in full working order. In case of a failure to the electrical supply serving the public address system fully functioning loud hailer must be available for use. The Holder shall provide a Safety Officer's Control Point within or in close proximity to the Regulated Stand, which must:
- a. accommodate the necessary communications equipment and be a base for the staff required for their operation or supervision;
 - b. be suitable to serve as a command post in the event of an emergency; and
 - c. be capable of being evacuated safely if necessary.

SCHEDULE C - FIRST AID AND MEDICAL FACILITIES

C.1. Accommodation and Equipment

- C.1.1 The Holder shall provide a Dedicated First-Aid Room which is suitable in size, fitting and facilities and design and location (see Green Guide for details) and is available for use during each Specified Activity. The Dedicated First-Aid Room should have a W.C. suitable for use by disabled people adjacent to it, together with a wash basin and hot and cold water supply.
- C.1.2 The Holder shall clean, heat, light, ventilate and maintain the Dedicated First-Aid Room, which shall be used solely for first aid purposes. The Holder shall ensure that all appropriate standards of hygiene are maintained.
- C.1.3 The Dedicated First-Aid Room shall be accessible to first aid personnel, ambulances and the public from every part of the ground, and shall be suitably sign-posted throughout the Regulated Stand.
- C.1.4 Instruction notices for contacting the Emergency Services shall be displayed in the Dedicated First-Aid Room.
- C.1.5 The Holder shall ensure appropriate medical provisions are available for Spectators during any Specified Activity. The Holder shall ensure that where a Safety Officer, Deputy Safety Officer or Specified Person is required to be present during a Specified Activity, a medical risk assessment shall be conducted by a Competent Person. Consultation shall take place as necessary with the local Ambulance Trust and first aid providers. The Holder shall ensure the development and implementation of a medical plan, which incorporates any control measures as outlined within the medical risk assessment as necessary. The medical plan shall define the levels of medical provision for spectators, subject to a minimum requirement of two first aiders to be present during any Specified Activity.
- C.1.6 The Holder shall ensure that defibrillators are provided at all Specified Activities, whether they are provided by the Club or supplied through a medical/ first aid provider. The Holder shall ensure that there are an adequate number suitably trained persons at a Specified Activity to operate a defibrillator.

SCHEDULE D - BUILDINGS, STRUCTURES AND INSTALLATIONS

D.1. Means of Ingress and Egress

- D.1.1 The means of ingress and egress shall be maintained in good condition and unobstructed to each part of the Regulated Stand.
- D.1.2 Means of ingress and egress to each part of the Regulated Stand and all signage relating thereto shall be adequately maintained and shall be marked in a manner that can be understood by Spectators.
- D.1.3 Each exit gate shall be available for egress during any Specified Activity.
- D.1.4 During a Specified Activity, no door or gate forming part of an escape route from the Regulated Stand shall be locked by a key or fastened in such a way that it cannot easily and immediately be opened by those using that route in an emergency.
- D.1.5 'WAY OUT' or 'EXIT' notices shall be provided and maintained over each exit within the Regulated Stand.
- D.1.6 Each gangway, exit route, stairway, ramp, stepping and means of access for emergency vehicles to the Regulated Stand shall be kept free of stored goods, litter, ice and snow whilst the Regulated Stand is in use for any Specified Activity. The treads of steps and stairways shall be maintained with non-slip and even surfaces, and shall be adequately drained.
- D.1.7 Gangways on terraces within the Regulated Stand shall be in a conspicuous colour with a non-slip surface. Conspicuous nosings shall be provided to stepped gangways in seated areas. All gangways shall be kept clear of Spectators.
- D.1.8 The Services Rendezvous Point for the Emergency Services shall be provided as indicated on the Plan contained in Appendix 4
- D.1.9 The means of access for Emergency Service vehicles to the Regulated Stand shall be maintained unobstructed and in good condition

D.2. Electrical, Mechanical And Heating Installation

- D.2.1 The electrical installation for the Regulated Stand shall be maintained in accordance with the latest BS 7671 British Standard Requirements for Electrical Installation (IEE Wiring Regulations).
- D.2.2 A diagram of the main electrical distribution arrangements shall be fixed in an easily accessible positions for reference by Competent Persons. All switch and control gear shall be clearly labelled to indicate the circuits which they control.
- D.2.3 All cables and conductors of wiring systems shall be sited so that they are, as far as practicable, inaccessible to the public and shall be enclosed throughout in a protective covering of material which has sufficient strength to resist mechanical damage. Where wiring is to be used within confined spaces such as escape routes, Low Smoke and Fume Emission (LSF) sheathed cables should be used.
- D.2.4 An alternative electricity supply which functions for a minimum of 3 hours in the event of failure of the normal supply shall be provided and shall be sufficient in power to simultaneously run all of the following systems effectively

- a. Emergency Lighting
- b. Escape Lighting
- c. Fire alarm
- d. Other apparatus/areas where required

Note: Where a generator is used to provide the alternative supply, the start-up time of the generator should not exceed 5 seconds

- D.2.5 All Emergency Lighting shall automatically provide illumination in the event of a failure of a lighting circuit or mains electricity supply.
- D.2.6 All Emergency Lighting shall provide a level of illumination which is adequate to allow free movement within the Regulated Stand and exits therefrom.
- D.2.7 The heating installation (including all boilers, calorifiers and safety devices) for the Regulated Stand, shall be maintained by the Holder in a safe and satisfactory condition; shall be housed in a Fire Resisting enclosure; shall be fitted with automatic energy cut off device(s); shall have an adequate air supply and shall not prejudice the means of escape for Spectators. The installation shall also be examined as required by Schedule F. Any Gas Installations shall be provided and maintained in accordance with the Gas Safety Regulations.
- D.2.8 The Holder must ensure that there is a Competent Person or persons either on site or readily available during any Specified Activity to deal with any problems which might arise in relation to the electrical or mechanical Installations at the Regulated Stand.

D.3. General

- D.3.1 No temporary sales kiosk or stall or other temporary structure (including any mobile stall) shall be installed without prior written consent of the Certifying Authority. Liquefied Petroleum Gas shall not be used unless written consent is obtained from the Certifying Authority.
- D.3.2 The following areas shall be kept completely free of storage, goods, litter, combustible or flammable material or other obstruction and access must be maintained at all times:-
 - a. Cupboard containing electrical distribution board and PA equipment;
 - b. The outside area to the rear of the Regulated Stand;
- D.3.3 No cylinder for the storage of compressed air, oxygen, hydrogen or other gas or liquid under pressure shall be used or stored in the Regulated Stand
- D.3.4 No special effects, displays or other arrangements (including pyrotechnics, lasers etc.) within the Regulated Stand shall be undertaken without consultation and written prior consent of the Certifying Authority.
- D.3.5 The Holder shall ensure that all seating is maintained securely fixed in position, suitably numbered and that damaged seats are promptly repaired or replaced.
- D.3.6 Television cameras, commentary points, camera gantries and the location of outside broadcast vans, for the broadcast or recording of specified activities, and including cables and other portable equipment, shall be specified on plans and submitted to the Certifying Authority for consultation four weeks prior to for the broadcast or recording of the specified activities.

SCHEDULE E - FIRE AND FIRE FIGHTING

E.1. General

- E.1.1 The Holder is required to ensure fire safety arrangements are planned, organised, controlled, monitored and reviewed to effectively prevent the outbreak and spread of fire, alert persons to the presence of a fire, and evacuate persons to a safe area
- E.1.2 The Holder is required to ensure that the arrangements as required in E1.1 above are documented within a fire safety management plan.
- E.1.3 The Holder is required to ensure that suitable and sufficient documented risk assessments are completed. The control measures identified within these risk assessments should be incorporated into the documented fire safety management plan.
- E.1.4 Fire risk assessments should assess all Structures and Installations at the Regulated Stand and external Installations in close proximity to the Regulated Stand that may have an impact on fire safety at the Regulated Stand.
- E.1.5 This assessment should be reviewed on an annual basis or sooner if changes /incidents occur that affect fire safety and/or its management.
- E.1.6 The Holder shall ensure that persons competent in fire safety provisions develop and manage the fire safety management plan and risk assessments.
- E.1.7 An effective fire safety management plan should consider the following fire safety aspects within the Regulated Stand:-
 - a. Identifying, removing, reducing the sources of ignition and fuel;
 - b. Restrict the rate of early fire growth and fire spread;
 - c. Provide sufficient protected emergency evacuation routes;
 - d. Provisions for evacuation people with disabilities;
 - e. Adequate provision and illumination of exit and emergency evacuation route through appropriate signage and Emergency Lighting;
 - f. Effective fire detection and warning systems;
 - g. Appropriate firefighting equipment;
 - h. Appropriately trained staff in fire safety and where applicable the use of firefighting equipment;
 - i. Unobstructed access, egress and parking for emergency vehicles at all times;
 - j. Preventative maintenance and tests for fire safety equipment;
 - k. The use of lifts should also be considered regarding fire safety.
- E.1.8 The Holder is required to ensure that there are effective systems in place to monitor the implementation of the fire safety management plan and ensure its effectiveness.

SCHEDULE F - TESTING AND INSPECTION BY THE HOLDER

F.1. Introduction

- F.1.1 The Holder shall ensure the following briefing sessions, checks, inspections and tests are carried out and records kept as specified in Schedule G.
- F.1.2 Any defect found as a result of checks, inspection and tests or otherwise shall be recorded in the Defects Log Book, which shall record when the defect is discovered and when it is remedied. All defects should be reported to the Safety Officer, Deputy Safety Officer or Specified Person as soon as is reasonably practicable. There must be a system in place for the organisers of a Specified Activity to report any defects to the Holder.
- F.1.3 Where it has been determined that a Safety Officer, Deputy Safety Officer or Specified Person is not required at a Specified Activity, the Holder shall ensure instructions to the organiser of a Specified Activity to enable them to comply with F4.

F.2. Inspections and tests before a Specified Activity

- F.2.1 The Holder shall ensure the following are inspected and tested at least 24 hours before the Specified Activity and ensure the instigation of adequate contingency measures if there is a failure to ensure any defects can be corrected before a Specified Activity:-
 - a. loud hailers, radio systems, public address systems and Emergency Lighting systems.
 - b. The automatic fire detection and fire warning systems (including the repeater panel), which shall be tested in accordance with the method laid down in BS5839: Part 1.
- F.2.2 All inspections, tests and checks shall be documented together with any problems identified and corrective actions taken.
- F.2.3 If problems are identified, the Holder shall ensure appropriate remedial action is taken before the public is allowed access to the affected area of the Regulated Stand.
- F.2.4 The Holder shall ensure the following items are carried out within the Regulated Stand before the start of each Specified Activity;-
 - a. inspect the general condition and state of maintenance of the fabric of the Regulated Stand, paying particular attention to the condition of each terrace, stairway, exit route, access route and directional sign;
 - b. inspect all gangways, entry, exit and access routes to ensure freedom from obstructions and trip hazards; and that surfaces are not slippery and are capable of being used to their full capacity;
 - c. examine each crush barrier and balustrade for corrosion, deformation or any other visible weakness; and ensure all structures are free from damage, corrosion or deformation which might cause a potential danger to the public;
 - d. remove and dispose of all potential missiles, rubbish and combustible waste and clear each exit, stairway, exit route, boiler room, electrical intake room, void and all areas to which the public have access, including the means of access for Emergency Services vehicles; of goods, litter, combustible or flammable materials, unauthorised products or other obstruction or hazard;

- e. examine all exit doors and gates whether manually or electronically operated to ensure that they can be easily and fully opened.
- f. inspect all voids and all other areas particularly vulnerable to fire for combustible materials or other hazards, and ensure that hazardous materials are removed, or safely stored, well away from public areas;
- g. ensure that the required fire fighting equipment is in position and available;
- h. inspect the Dedicated First-Aid Room and the equipment and supplies held there and ensure that sufficient first-aid personnel are present.
- i. ensure containers used to store combustible waste or litter are secure;
- j. ensure that areas to which public access is prohibited are properly locked or sealed off;
- k. ensure that directional signs are in place and, where appropriate, illuminated;
- l. ensure that media activities do not interfere with, or negate, the normal safety operation of the Regulated Stand and do not hamper the safety, comfort or viewing standards of Spectators.

F.3. Inspections and tests during and after a Specified Activity

F.3.1 During each Specified Activity in the Regulated Stand, the Holder shall ensure the following: -

- a. litter and waste are not allowed to accumulate, and are removed to secure containers whenever possible;
- b. materials are not allowed to accumulate or be stored in circulation, exit or escape routes; and
- c. all aisles, exits, emergency exits and escape routes are kept clear.

F.3.2 After each Specified Activity, the Holder shall ensure: -

- a. That a general visual inspection of the Regulated Stand is carried out to identify signs of damage or deformation which might create a potential danger to the public, with particular attention to the condition of seats, terraces, viewing slopes, barriers and stairways;
- b. that combustible waste and litter in the Regulated Stand are cleared (particularly from voids) and either removed or stored in secure containers;
- c. participation with the ambulance officers and first-aiders in a de-briefing and record any comments and follow up action;
- d. that any outstanding matters of concern are recorded and arrangements made for remedial action before the next Specified Activity; and
- e. liaison with the Police and/or crowd control personnel to gain full benefit from any de-briefing about crowd control.

F.4. Periodic Inspection, testing and servicing of all Installations

F.4.1 The Holder is required to ensure that a 'Planned Preventative Maintenance Schedule' is prepared that covers the inspection, testing, and servicing of all Buildings, Structures and Installations in accordance with the specifications detailed below.

F.4.2 The Holder shall ensure detailed annual inspections of the Regulated Stand components as described as follows are carried out by appropriately Competent Persons:-

- a. All standing surfaces, seats, stairs, ramps, doors, gates, boundary walls, fences and cladding are fit for their intended purpose;

- b. All load bearing elements are capable of withstanding the loads to which they are likely to be subjected and that they perform properly their required functions
- c. All barriers and handrails shall be tested in accordance with the Green Guide;
- d. Where barriers and handrails fail to meet these test conditions they shall be replaced or strengthened. Such barriers and handrails shall be retested after the remedial work to ensure compliance.

F.4.3 An inspection and 3-hour full load test of the Emergency Lighting batteries shall be carried out by a Competent Person. Where self-contained battery operated escape luminaires are installed, the certificate shall confirm that each luminaire has been energised from its battery for 3 hours. Tests shall be carried out at least every 12 months. Copies of certificates with the test results shall be submitted to the Certifying Authority at least once in every 12 months.

F.4.4 The manual electric fire alarm, automatic fire detection equipment and public address system in operation in the Regulated Stand shall be tested by a Competent Person and a certificate shall be submitted to the Certifying Authority confirming that they are in a satisfactory condition at least once in every 12 months.

All firefighting equipment in the Regulated Stand shall be maintained in accordance with [BS EN 671-1:2001](#), BS.5306: Parts 1 and 3 BS EN 3-10:2009 and BS EN 1869:1997 as appropriate by a Competent Person or company of fire engineers and a record kept. An inspection and maintenance certificate in respect of all firefighting equipment at the Regulated Stand shall be submitted to the Certifying Authority once in every 12 months.

F.4.5 The Holder shall ensure the following are inspected and tested at regular intervals. Regular intervals in each case should be determined by a suitable and sufficient risk assessment:-

- a. Inspections of extinguishers, spare gas cartridges and replacement charges shall be carried out to ensure that extinguishers are in their correct positions and have not been discharged or suffered a pressure loss or damage. The results of the inspections shall be entered in a log book.
- b. The electrical Installations shall be inspected and tested and a periodic inspection report, in the form prescribed by the IEE Wiring Regulations, shall be submitted to the Council. The certification of the whole of the stands electrical installation as satisfactory by a Competent Person at least once every 3 years.

F.5. Detailed Structural Appraisal

F.5.1 A risk based plan for the detailed appraisal of all structures and parts of structures within the Regulated Stand should be kept in accordance with the relevant section of the Green Guide.

SCHEDULE G - RECORDS AND CERTIFICATES

G.1. Records To Be Kept By The Holder

G.1.1 The Holder shall keep, separately, for a minimum period of six years, the following records which shall be made available for inspection by the Certifying Authority's authorised officers or representatives of the Sports Grounds Safety Authority (SGSA) at all reasonable times. The Holder shall be responsible for the collation of the information required for the records from the relevant organisation. Each record shall specify the name, status and qualifications of any person carrying out a test, inspection or remedial work:-

- a. a record of any accident or incident which causes injury in the Regulated Stand which is brought to the notice of the Holder and which occurs whilst the Regulated Stand is in use for a Specified Activity;
- b. a record of any risk assessment as required in Schedule B section B1.3
- c. a record of the names of Stewards on duty at each event and the Stewarding positions within the Regulated Stand, as specified in Schedule B section B.2;
- d. a record of details, including attendance, of each training session and pre match/event briefing given to staff and Stewards as specified in Section Schedule B section B.3;
- e. a record of contingency/evacuation training sessions undertaken in accordance with Clause 13 and Schedule B, B7.3.
- f. a record of the numbers and posts of all first-aiders present on each occasion.
- g. a record of all first-aid or medical treatment provided during or in connection with any Specified Activity;
- h. a record of tests of fire alarms and automatic fire detectors and public address system as specified in Schedule F;
- i. a record of tests of firefighting equipment as specified in Schedule F;
- j. a record of tests of the Emergency Lighting, as specified in Schedule F;
- k. a record of all pre-event inspections as specified in Schedule F;
- l. a record of each inspection carried out at the Regulated Stand to ensure compliance with Schedule F;
- m. a record in a Defects Log Book of any defect relating to the safety of the Regulated Stand in accordance with F1.2;
- n. a record of all fire alarms whether or not activated by the automatic fire detector system;
- o. a record of all substantial maintenance work and improvements relating to safety carried out at the Regulated Stand;
- p. a record of any non-routine opening of an exit door or gate; and
- q. a record of any assumption of control by the Police.

G.2. Certificates

G.2.1 The Holder shall submit an up-to-date copy of the certificates as required by Schedule F to the Certifying Authority on an annual basis.

G.2.2 The Holder shall ensure that all records are kept fully up to date in a tamper proof form. The records shall be kept together in a specified place along with a copy of this certificate and its related documentation.

APPENDIX 1 SPECIFIED ACTIVITIES

ACTIVITIES COVERED BY THE CERTIFICATE

Athletics

American Football

Rugby

Football

APPENDIX 2 PERMITTED NUMBERS OF SPECTATORS

The maximum number of Spectators that may be admitted to the Regulated Stand at any one time shall be restricted to: -

Seated Spectator Accommodation - 703 Spectators

Wheelchair Spectator Accommodation – 29 Spectators with Carers.

The maximum number of Spectators in wheelchairs can be increased for wheelchaired Spectators who do not have or require assistance of a Carer to evacuate the stand. The maximum capacity should be determined by dimension calculations (detailed in the Green Guide see Note below) and an assessment to ensure that the capacity allows wheel chair Spectator to manoeuvre easily to a space that allows them a clear view of the Specified Activity.

Note – (Dimensions detailed in the Green Guide)

Space required for a wheel chair Spectators without a Carer – dimensions least 900mm (width) X 1400mm (depth).

Space required for a wheel chair Spectators with Carer - dimensions least 1400 (width) X 1400mm (depth).

APPENDIX 3 PLAN (Ref - Drawing Number POS/121001/15-2)

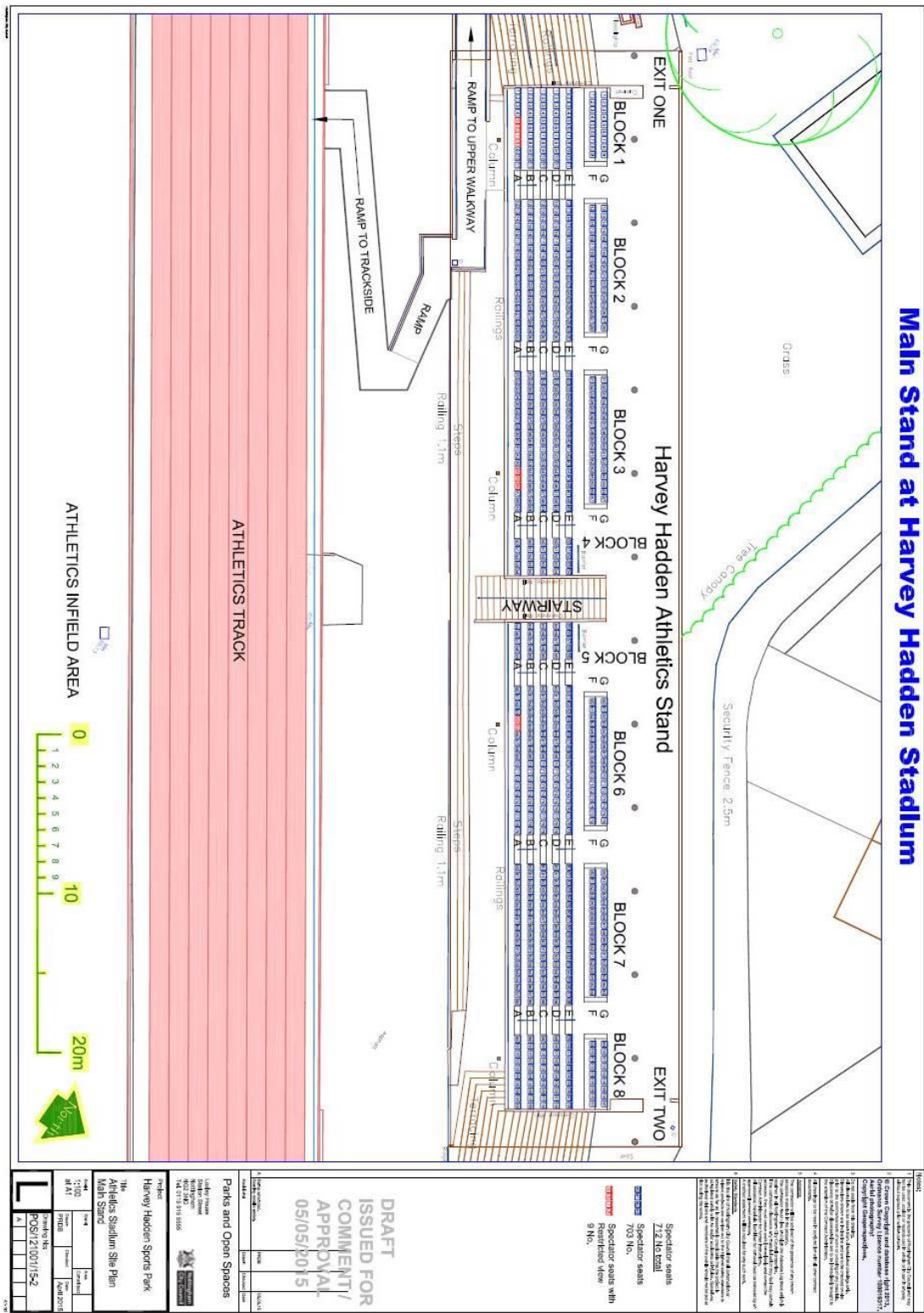

APPENDIX 4 PLAN OF EVACUATION (Ref Drawing

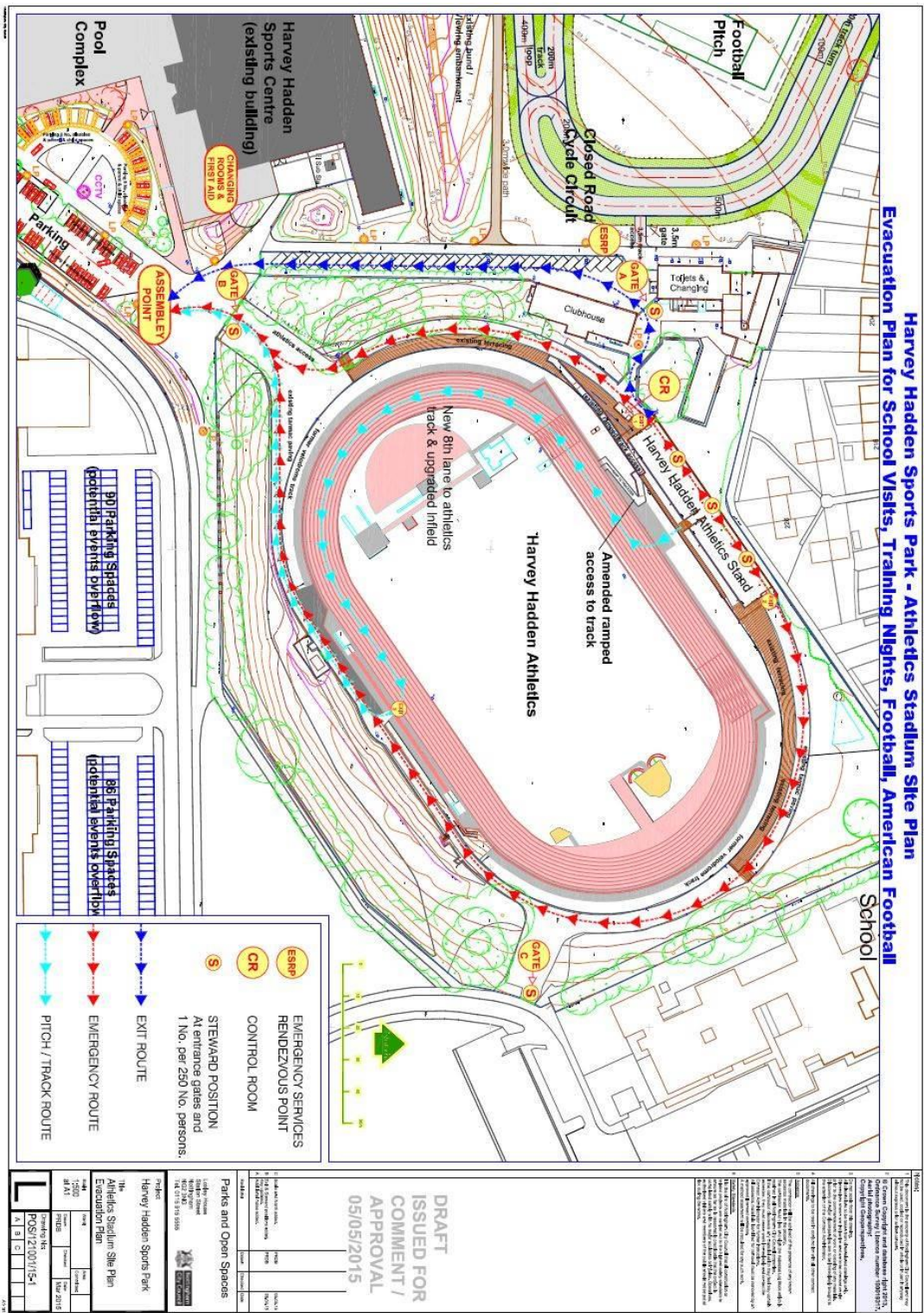

APPENDIX 5 DEVIATIONS FROM THE RECOMMENDATIONS IN THE GREEN GUIDE

Deviations	Green Guide	Remarks
Rear Barrier	(Pg. 95) Where the rear of the stand is open, type 6 barriers behind a row of seats should be a minimum of 1.1m, measured from seat level	It is considered that the back of the Regulated Stand is not open and that risk of persons falling can be effectively managed through Stewarding.
Telephones	Telephone lines should be available for direct and immediate telephone communication between the control point and the fire service and/or other Emergency Services	There are no external lines available in the control room. Mobile phone provision during a Specified Activity is a pre-requisite within policies and procedures.
First Aid Room	First aid room should easily accessible to Spectators	The first aid room is located within the Harvey Hadden Leisure Complex and is not within the Regulated Stand.
Public address system back-up power supply	The back-up power supply to the public address system should be such to enable it to continue to function at full load in an emergency, such as a fire or a failure of the mains supply for up to three hours.	There is no back-up power supply for the public address system – fully functioning loud hailer must be available for use in the event of failure of the public address system.
Lightning protection system	The Regulated Stand lightning protection system shall be tested by a Competent Person and a certificate confirming that it is in a satisfactory condition shall be submitted to the Certifying Authority at least once in every 12 months.	There is no lightning protection system on this Regulated Stand
Requirements of a Safety Officer	(Pg. 30) It is recommended that a safety officer should as a minimum have, or be working towards, a level 4 spectator safety qualification on the relevant qualification framework.	a 'Specified Person', i.e. a person holding the necessary ability, knowledge, and skill as agreed with the Certifying Authority who does not meet the requirement within the Green Guide to be 'occupationally competent' (hold or be working towards a level 4 spectator safety qualification) may carry out the duties of the Safety Officer for certain specified, low risk events, with the express written consent of the Certifying Authority only.